



WHITNELL WAY ESTATE

Landscape: Play

OUR SITE BOUNDARY



EXISTING PLAY AREA LOCATION

EXISTING PLAY OFFER

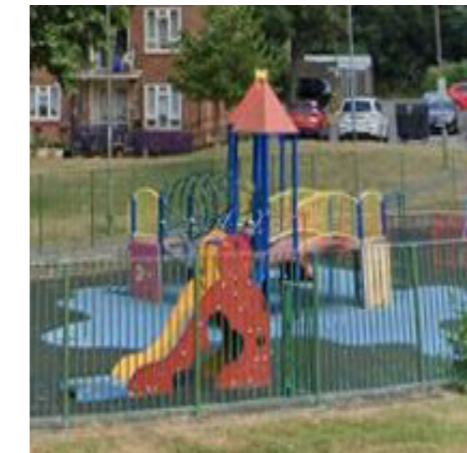

GENERAL

- Size: ~400m²
- 1.1m high metal fence
- Gated access
- Sunken play area
- Age groups: 0-3 / 4-11

PLANTING

- None

SUMMARY

Vital playground for the estate in need of repair, enhancements and more varied play equipment.

PLAY OFFER (in need of upgrade)

- Spinning Disc
- Small Slide
- Double swings
- Climbing structure
- Rocking motorbike
- Rocking car

SURFACE

- Rubber crumb (in need of repair)

PLAY CONSULTATION

During the summer and as part of the consultation events we focused on getting feedback, thoughts and suggestions on the existing Whitnell Way playground. We encouraged children to design their dream playground whilst also engaging parents; we gathered some useful insights on how the existing play spaces are being used and created some wonderful play design collages

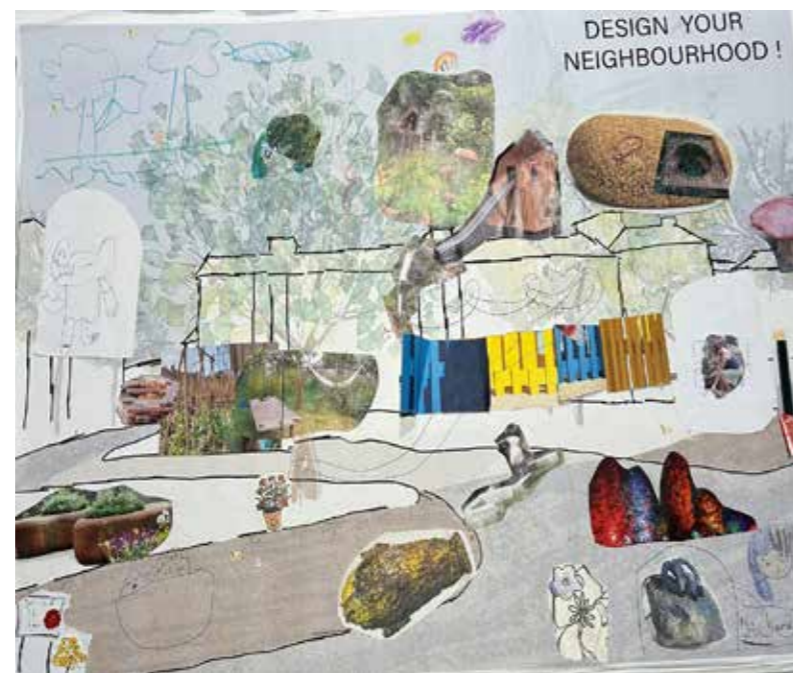

FENCES / GATES

Design boundaries in a more playful and less hostile way to make them softer, more useable for seating or a bespoke playable fence

EXISTING PLAY ELEMENTS

Possibility that the existing elements would lend themselves to be retrofitted

PLAY FLOW

Consider flow of activities and age groups when designing the play offer and journey

Consider quiet and active areas and how they flow into each other

LIGHTING

Integrate lighting whilst considering 'dark sky' / 'bat friendly' approach

PLANTING

Include planting both as playable elements and also as boundaries

Include elements that increase biodiversity

PLAY ELEMENTS

Main focus to be 4-12+ year olds with seating / shelters for older children

Include natural and accessible play equipment and an area for quiet play.

Consider in-ground trampolines / jumping discs

Consider themes of play and how they are integrated in the playground

Provide shade e.g. increase number of trees planted

Create welcoming and friendly entrances

PROPOSED PLAY OFFER

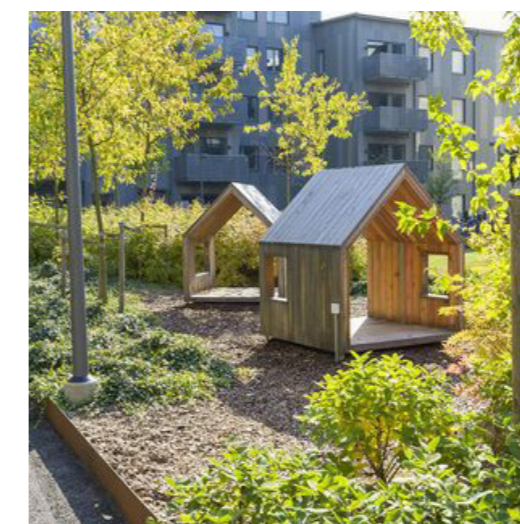

GENERAL

- Size: ~475m²
- Fence re-imagined as a playable boundary also usable for seating
- Gated access celebrated as arbour structures to make these welcoming and inviting
- Age groups: 0-4 / 5-11 / 12+

PROPOSED PLAY OFFER

- Swings (accessible)
- Climbing Structure
- Willow huts
- Balancing logs
- Play house
- Sand pit
- Wildlife pond
- Jumping discs

PLANTING

- More trees
- Sensory planting

SUMMARY

A more inviting and stimulating playground including a range of natural play elements influenced by the community and developed with Enable.

PROPOSED PLAY LOCATION



OPPORTUNITIES FOR INFORMAL / DOORSTEP PLAY

PROPOSED PLAY AREA LOCATION



WHITNELL WAY ESTATE

Landscape: Planting Palette



KEY

- Bee lawn: existing lawn enhanced
- Enhanced planting to fronts: building on what is already there
- Raingardens: tolerant to wet and dry condition
- Sensory planting: inviting to humans and wildlife



Enhancing what is there already and develop a planting palette that chimes with the existing lovingly crafted fronts

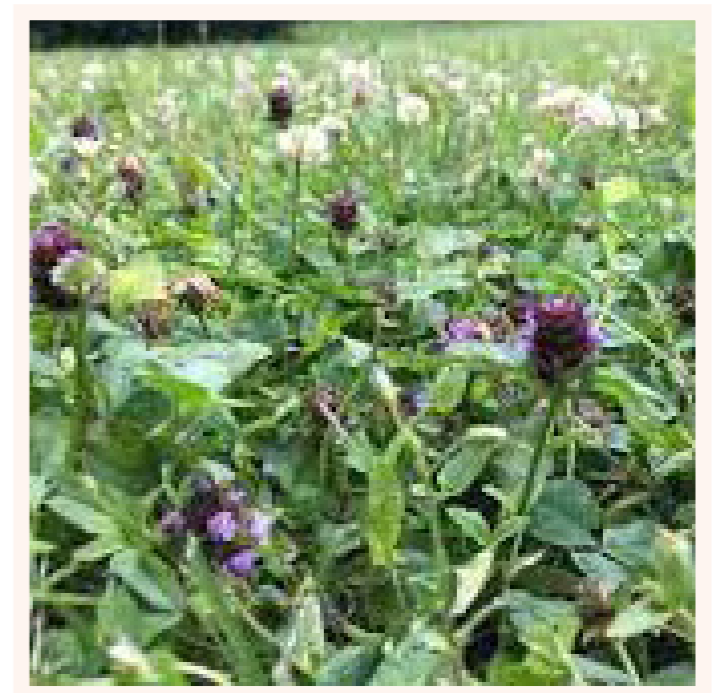

Existing lawn enhanced with species such as clover to increase biodiversity



Planting that is tolerant to wet and dry condition and helps to reduce surface water run off



Planting rich in textures and colour for educational aspects to encourage touch, sound and scent

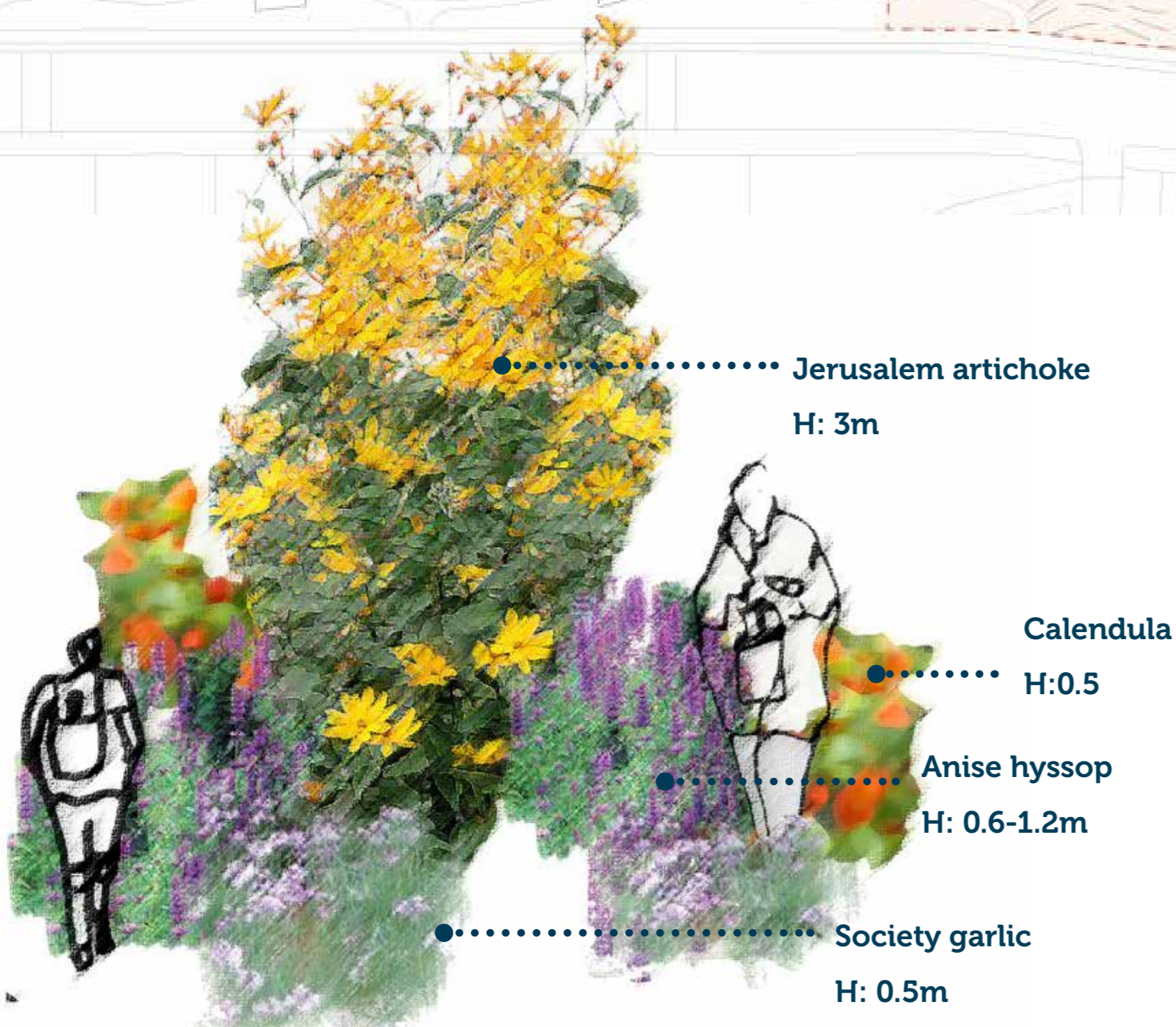

SENSORY PLANTING

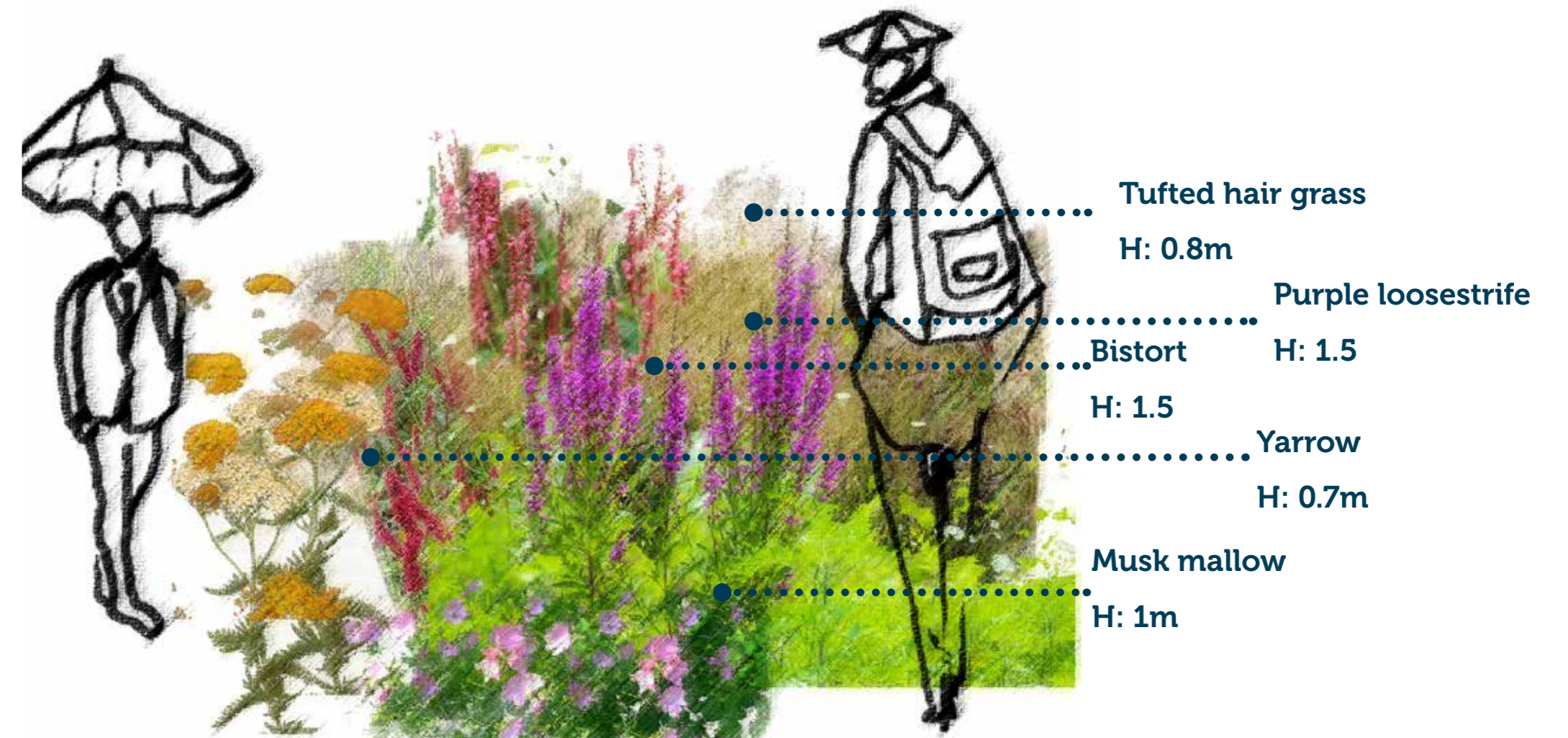

RAINGARDENS



ENHANCED PLANTING TO FRONTS



BEE LAWN